

# LEBANON BRANCH

LEBANON

TO

CINNATI

(The direction from Lebanon to Cincinnati is Westward)

34 5282' 33 5283' 32 5284' 31 5287' 30 5298' 29 5298' 28 5246' 27 5368' 26 2751'

71. WARREN COUNTY FARM BUREAU

- 71A.
- 72. CORWIN CANNING CO.
- 73. ENHAUSER MFG. CO.
- 74. STANDARD OIL CO.
- 75. LEBANON FARMER CO-OP
- 76. BRANTS INC.
- 77. FISHER COAL CO.
- 78. HORN & JONES CONSTRUCTION CO.
- 79. DAVE STEEL CORP.
- 80. STATE HIGHWAY DEPT.

(NOTE: TRACK BETWEEN  
LYTLE & LEBANON REMOVED  
1952 - MP 16 TO MP 25+)

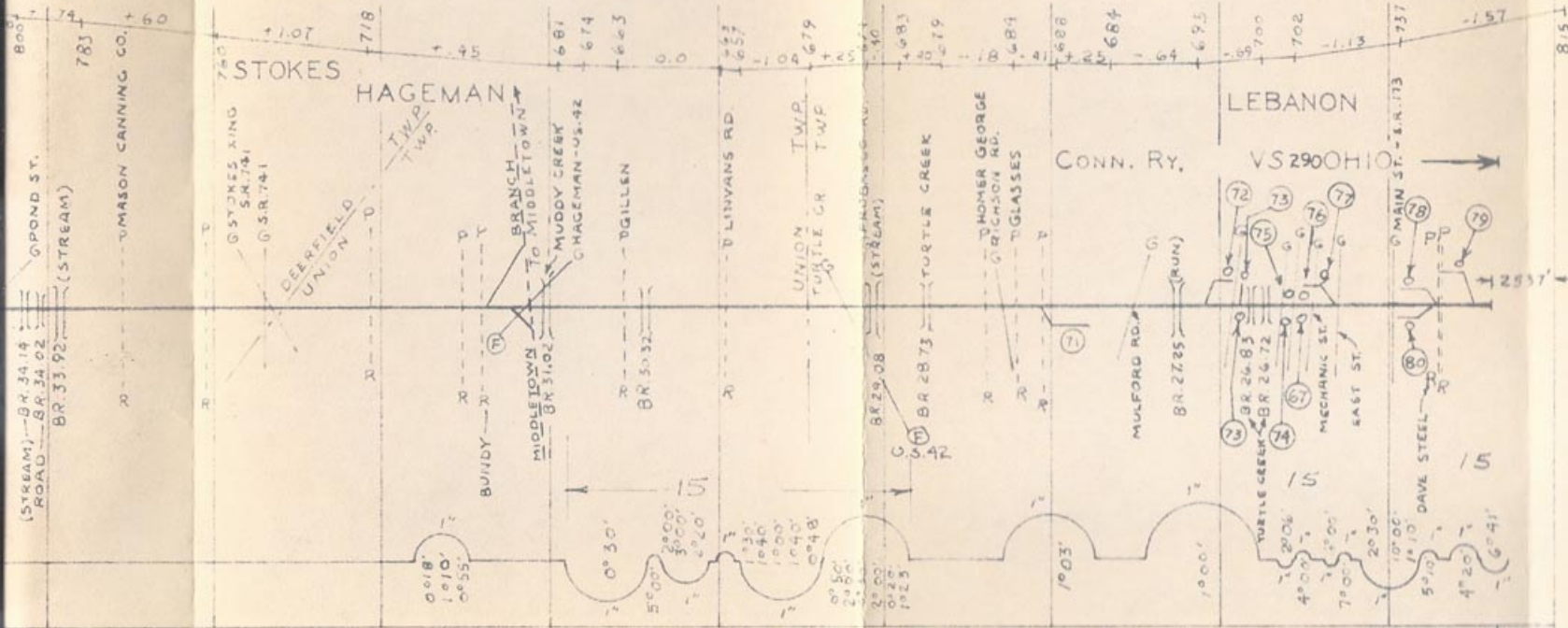

SUPERVISOR H. M. SHOAF

MORROW, OHIO

5343' 44 5282' 43 5284' 42 5282' 41 5283' 40 5282' 39 5284' 38 5288' 37 5278' 36 5282' 35 5282' 34 5282' 33 5283'

- 64 GENERAL ELECTRIC CO.
- 65 GENERAL FOODS CORP.
- 65A OHIO VALLEY WAREHOUSES, INC.
- 65B FORMCO, INC.
- 65C CHEVROLET DIV. OF G.M.C. WHSE.
- 65D CORAL HOMES
- 65E FIBREGLOSS EVERCOAT
- 65F TEXTILE PAPER CO
- 65G LINE MATERIAL INDUSTRIES

- 66 INTERNATIONAL PAPER CO.
- 67 WARREN COUNTY FARM BUREAU
- 68 MASON LUMBER CO.
- 69 WALKER FEED SUPPLY CO.
- 70 VALLEY KITCHEN DIST.

71. WARREN COUNTY FARM

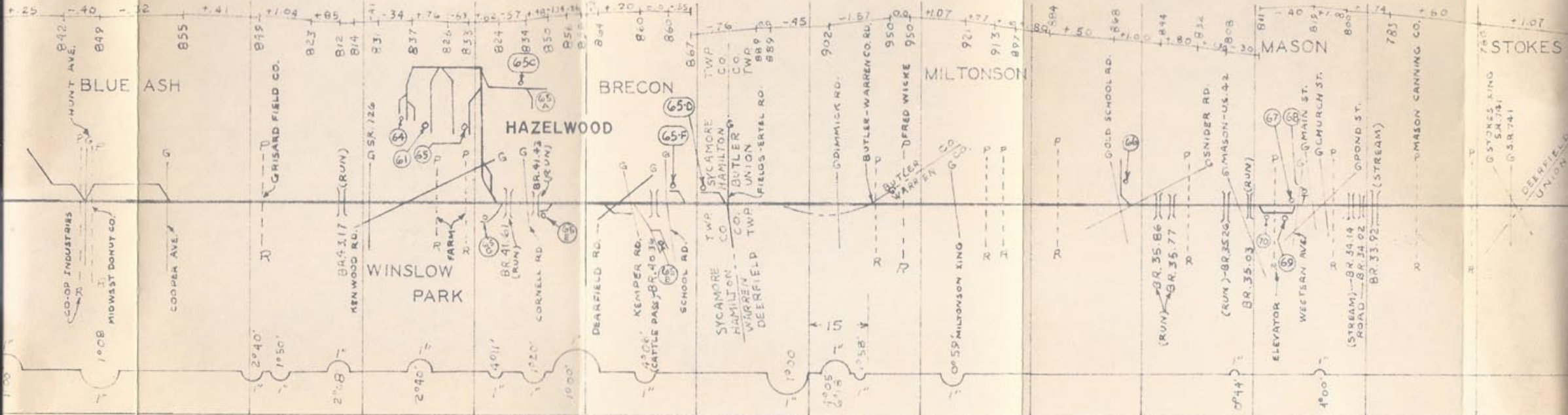

MAX. 20 M.P.H.

SUBDIVISION No. 9 SUPERVISOR H. M. SHOAR



5267' 48 5284' 47 5284' 46 5325' 45 5343'

RATHKAMP MOTOR SERVICE INC.  
ALPHA PORTLAND CEMENT CO.  
HARRY EWERS & SONS COAL CO. INC.  
NORWOOD SUPPLY CO.  
MEIER'S WINE CELLARS INC.  
SUPERIOR LUMBER & MILLWORK CO. INC.

57 FIBRE GLASS - EVERCOAT CO. INC.  
58 RAPE'S COAL & OIL CO.  
59  
60 GEIER MATTRESS CO.  
61 JEWEL TEA CO.  
62 STEEL CRAFT MFG. CO.  
63

64 C  
65 G  
65 A  
65 B  
65 C  
65 D  
65 E  
65 F  
65 G

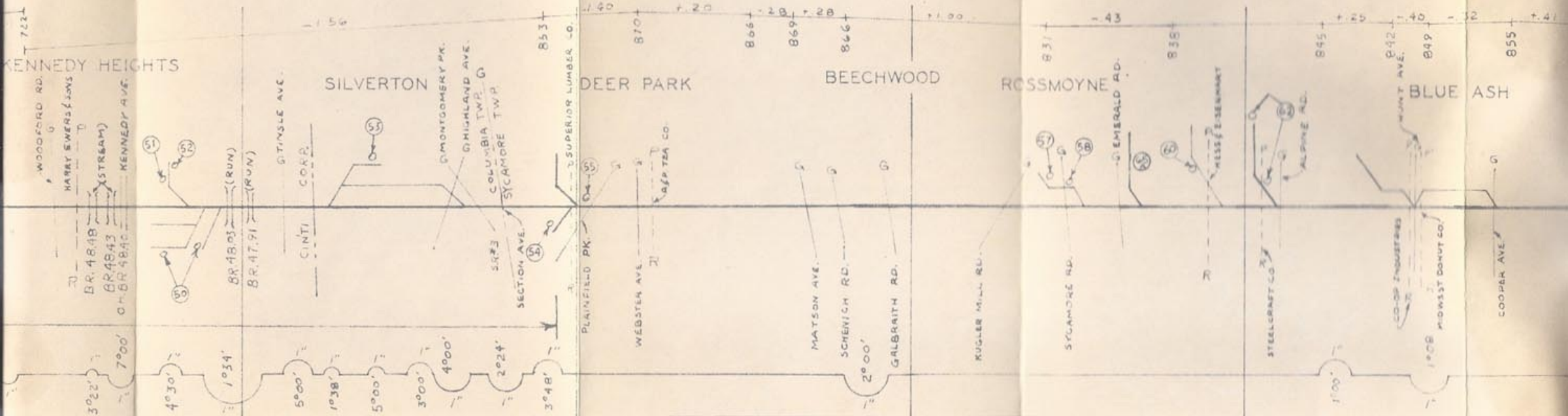

5293'

52

5267'

51

5280'

50

5232'

49

5267'

48

BLIND

- 31 CRAWFORD STEEL CONST. Co.
- 32 KEIDEL SUPPLY Co.
- 33 SPUR OIL Co.
- 34 BAUER FRANZ Co.
- 35 HUBER LUMBER Co
- 36 CREW BUILDERS SUPPLY Co.
- 37 STROWBRIDGE LITHOGRAPHY Co.
- 38 CHEVROLET DIV. G.M.C.
- 39 FISHER BODY DIV. G.M.C.
- 40 CANORA CORPORATION

- 41 SHEPHERD CHEMICAL Co.
- 42 C.W. ZUMBIEL Co.
- 43 NORWOOD WATER WKS.
- 44 MEAD CONTAINER CORP. (JACKSON BOX DIV)
- 45 HARRIS AVE TEAM TRACK
- A. TAYLOR-WHARTON Co. (DIV. OF HARSCO CORP)
- B. PERRY & DERRICK Co. INC.
- 46 CLEVELAND AUTOMATIC MACHINE Co.
- 47 F.F. TAYLOR Co.
- 48 KUTOL PRODUCTS Co

- 484 THE MILE CORP
- 48B J.H. DAY Co.
- 48C RAINBOW CRAFTS

- 49
- 50 RATHKAMP MOTOR SER
- 51 ALPHA PORTLAND CEMEN
- 52 HARRY EWERS & SONS CO
- 53 NORWOOD SUPPLY Co.
- 54 MEIER'S WINE CELLARS IN
- 55 SUPERIOR LUMBER & MILL
- 56

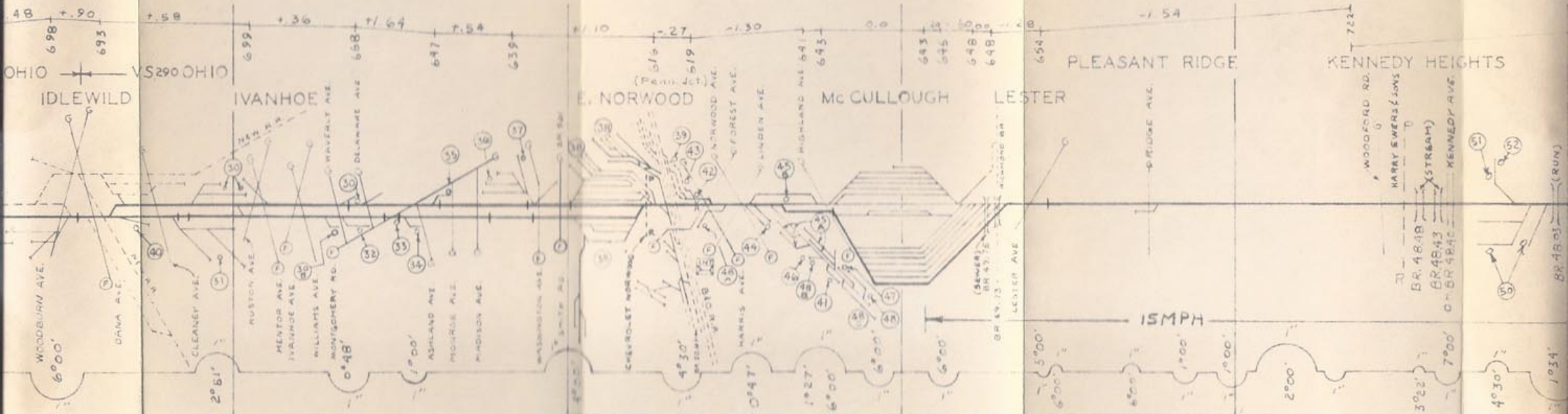

SUPERVISOR T.W. SMALLWOOD



AN Co.  
 BUILDERS SUPPLY Co.  
 BISCUIT Co.  
 CHOCOLATE MOTOR TERMINAL  
 TIRE & RUBBER Co.  
 GROCERY & BAKING Co.  
 PIANO Co.  
 OWN'S SON Co.  
 EL

11  
 12 CITY OF CINTI. ASPHALT PLANT  
 13 L&L DELIVERY  
 14 BARKER GREETING CARD Co.  
 15 SEARS ROEBUCK & Co.  
 16 CLEM LUMBER DISTR. Co.  
 17 AMERICAN BAKERIES Co.  
 18 FRISCH'S COMMISARY  
 19 ENTERPRISE LUMBER Co.  
 20 UNION CARBIDE CORP. (LINDE Co. DIVN.)

21  
 22 TEAM TRACK  
 23 GRINNEL Co.  
 24  
 25 J. J. HACKETT Co.  
 26 STANDARD BRANDS INC.  
 27 A&P TEA Co.  
 28 M&M METALS  
 29  
 30 FOY PAINT Co.

30-A CINCINNATI ASSOC. FOR BLIND  
 30-B CINCINNATI TOOL Co.

31 CRAWFORD  
 32 KEIDEL  
 33 SPUR  
 34 BAUER F  
 35 HUBER L  
 36 CREW BU  
 37 STROWB  
 38 CHEVROL  
 39 FISHER  
 40 CANORA

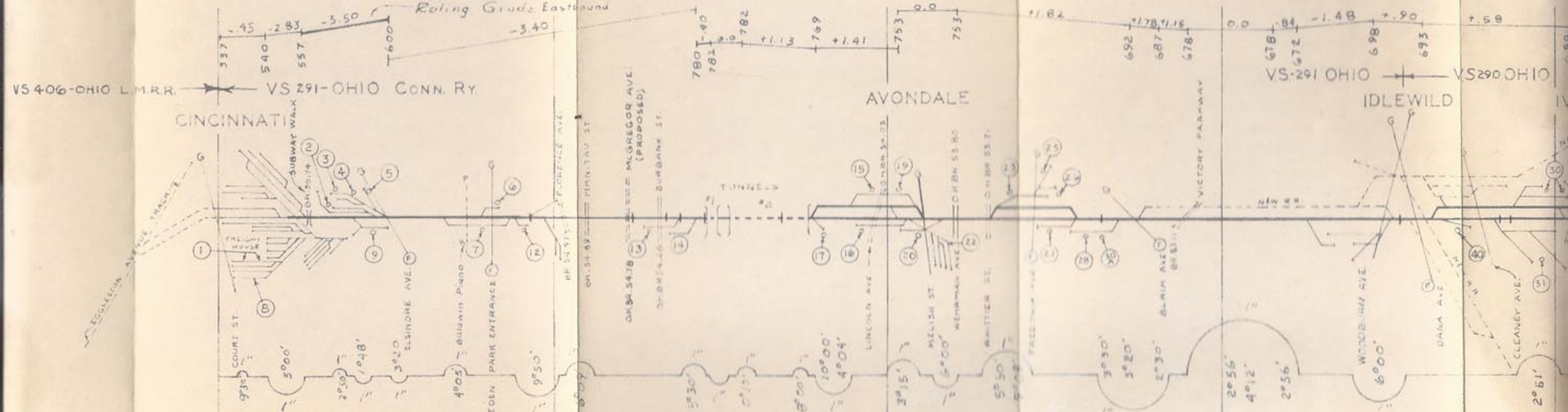

SUBDIVISION No. 10

- 1 HECKIN CAN CO.
- 2 CINTI. BUILDERS SUPPLY CO.
- 3 NATIONAL BISCUIT CO.
- 4 HERSHEY CHOCOLATE MOTOR TERMIN
- 5 FIRESTONE TIRE & RUBBER CO.
- 6 KROGER GROCERY & BAKING CO.
- 7 BALDWIN PIANO CO.
- 8 J.T.S. BROWN'S SON CO.
- 9 H. KNODEL

V5 406-OHIO L.M.R.R.

CINCIN

